

10 Carlson Court  
Suite 500  
Etobicoke, Ontario  
M9W 6L2  
tel: 416-674-7707

Version: 8.0    Date: March 2001

**Steeles Technology Campus  
Tower Building  
BOMA Assignments  
Floors 5,6,7,8 & 10 Typical**

**BOMA 1996 Areas**

Office Usable Area:	23,899 sq ft
Floor Common Area:	2,927sq ft
Building Common Area:	0 sq ft
Vertical Penetrations:	1,404 sq ft
Basic Rentable Area:	26,035 sq ft
Rentable Area:	27,663 sq ft

prepared by:

**extreme measures** inc.  
tel: 416-323-2858  
fax: 416-323-0855  
mail@xmeasures.com  
www.xmeasures.com

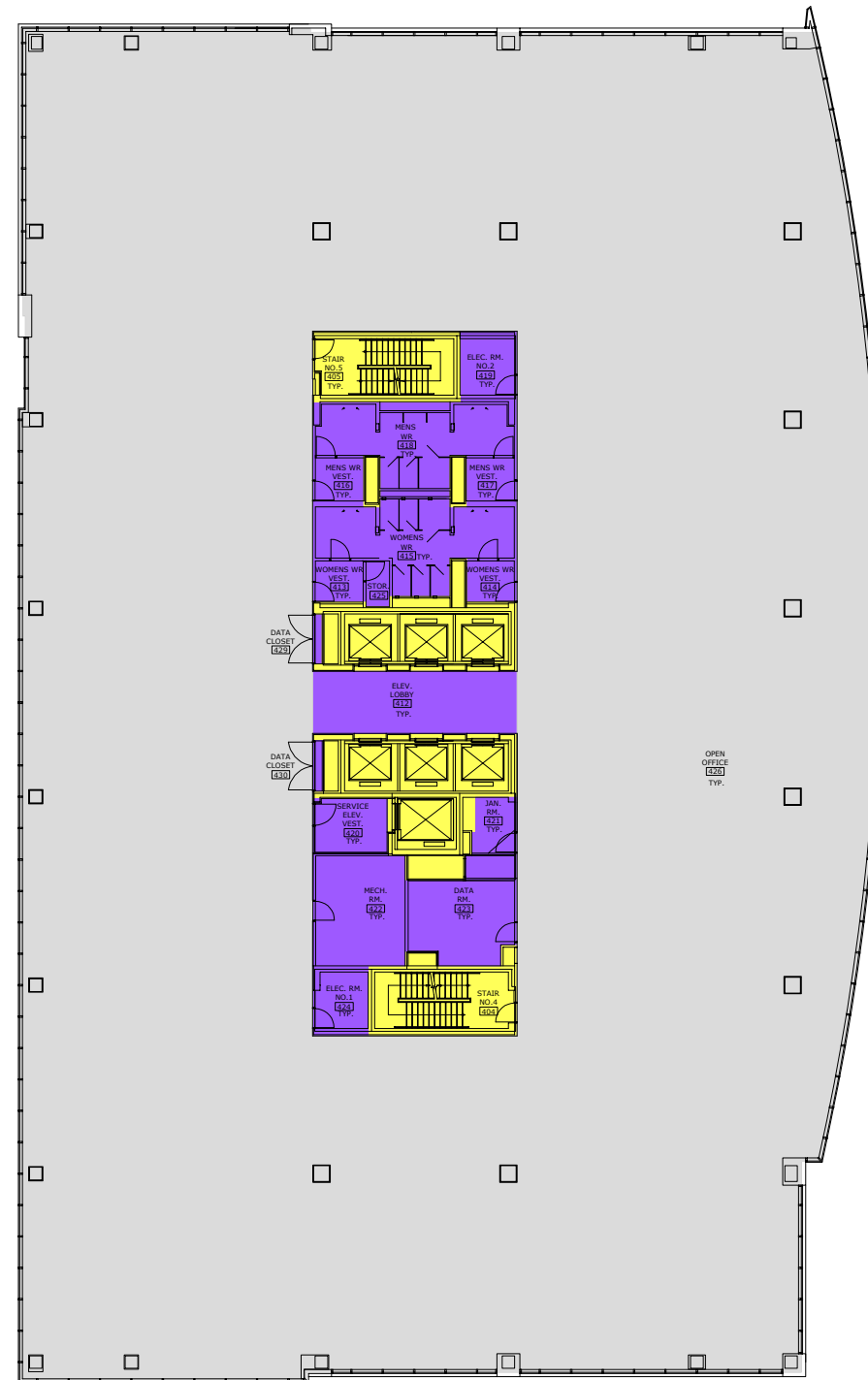

- Office Usable
- Retail Usable
- Floor Common Area
- Building Common Area
- Vertical Penetrations