

10 Carlson Court
Suite 500
Etobicoke, Ontario
M9W 6L2
tel: 416-674-7707

Version: 8.0 Date: March 2001

**Steeles Technology Campus
Tower Building
BOMA Assignments
Floor 11**

BOMA 1996 Areas

Office Usable Area:	21,814 sq ft
Floor Common Area:	2,092 sq ft
Building Common Area:	0 sq ft
Vertical Penetrations:	1,448 sq ft
Basic Rentable Area:	23,906 sq ft
Rentable Area:	25,401 sq ft

prepared by:

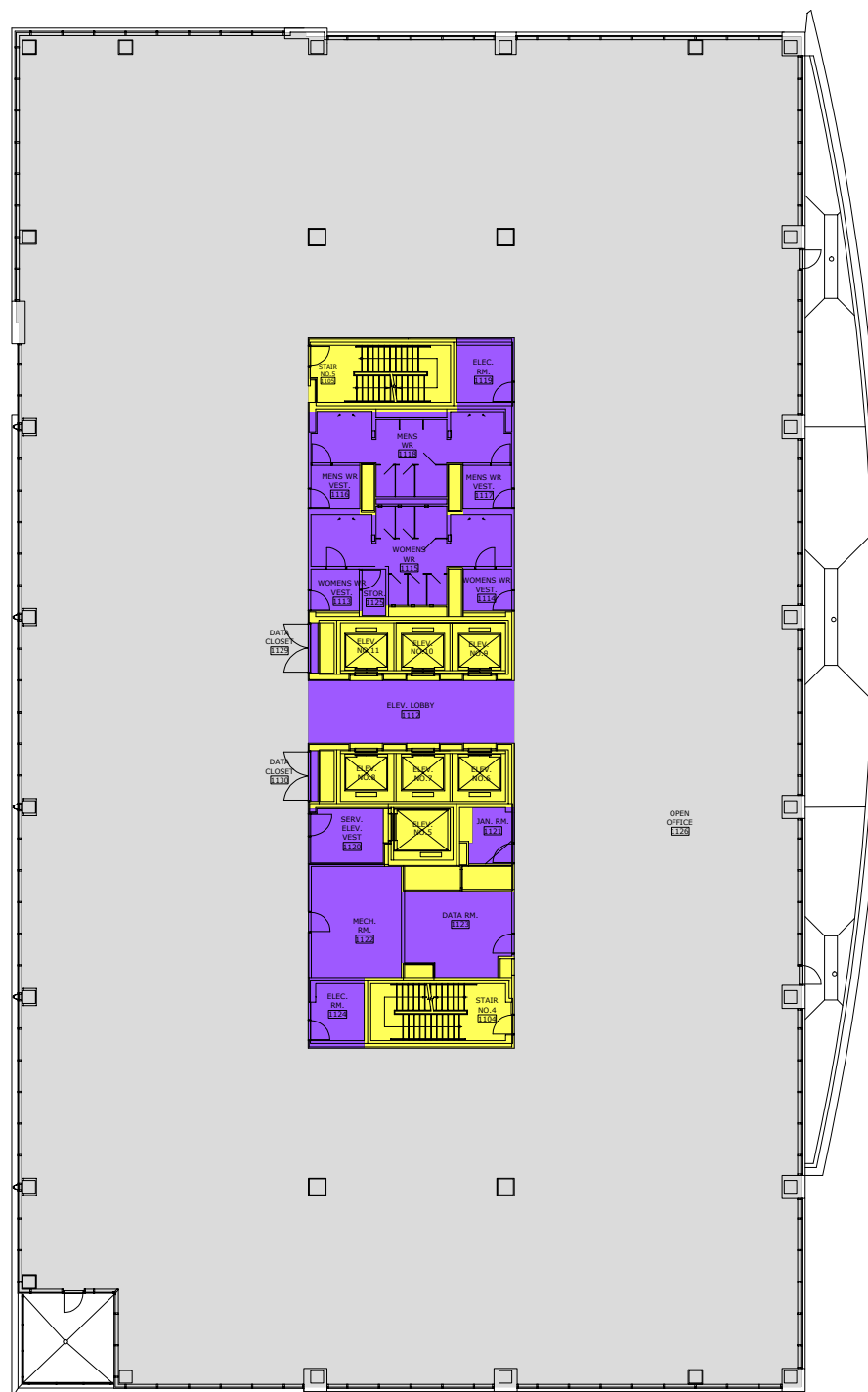

- Office Usable
- Retail Usable
- Floor Common Area
- Building Common Area
- Vertical Penetrations