

10 Carlson Court
Suite 500
Etobicoke, Ontario
M9W 6L2
tel: 416-674-7707

Version: 8.0 Date: March 2001

**Steeles Technology Campus
Tower Building
BOMA Assignments
Floor 3**

BOMA 1996 Areas

Office Usable Area:	23,924 sq ft
Floor Common Area:	2,107 sq ft
Building Common Area:	3,196 sq ft
Vertical Penetrations:	1,995 sq ft
Basic Rentable Area:	25,783 sq ft
Rentable Area:	27,395 sq ft

prepared by:
extreme measures inc. tel: 416-323-2858
fax: 416-323-0855
mail: xmeasures.com
www.xmeasures.com

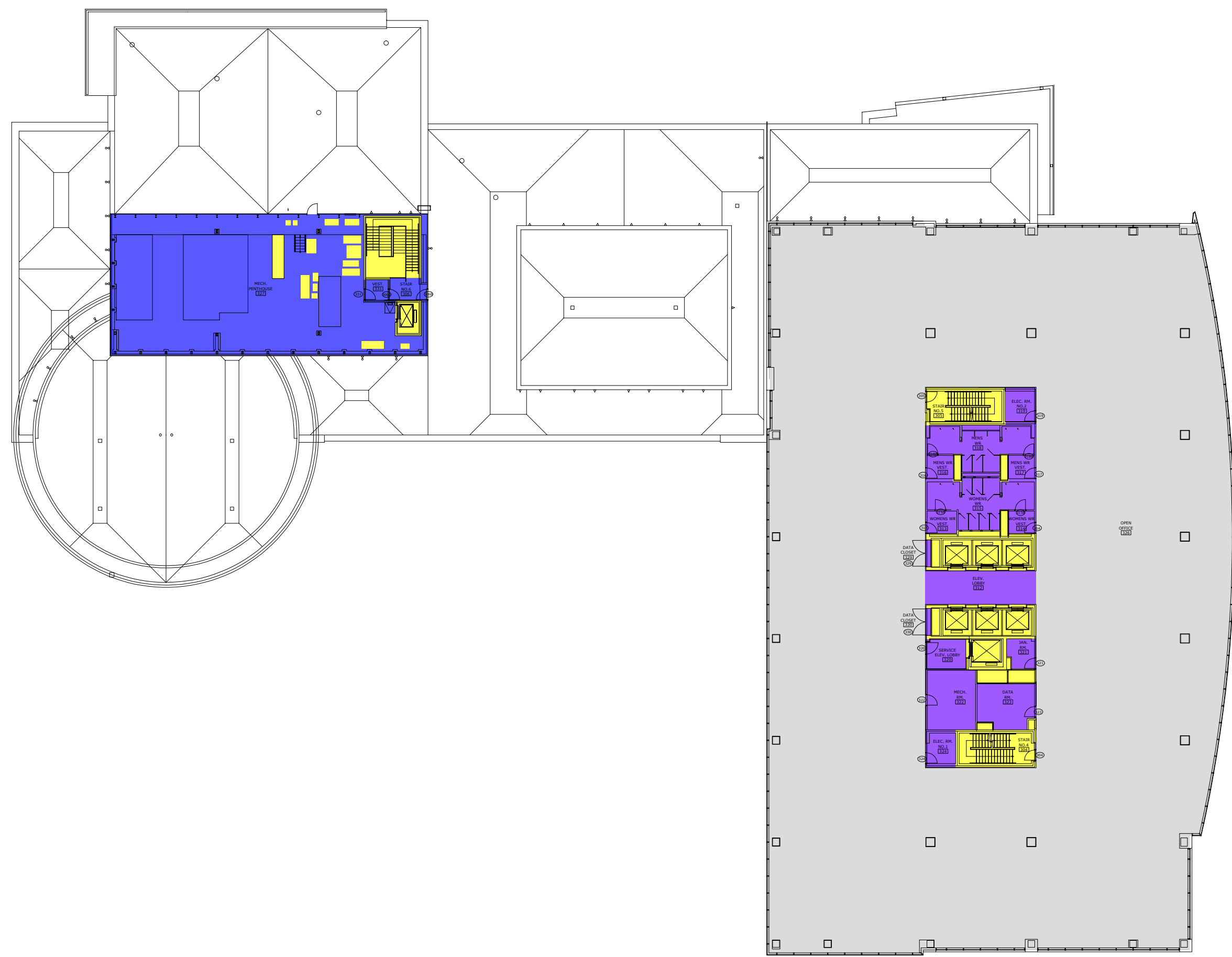

- Office Usable
- Retail Usable
- Floor Common Area
- Building Common Area
- Vertical Penetrations